

# The Creston Series

BLSPC - Linear Cove

Project		Date	
Part		Type	

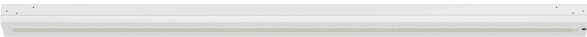

## About The Creston Series

The BLSPC is a series of LED linear cove strip fixtures, perfect for surface and suspended mounting. It offers high efficiency and is ideal for row-mountable task lighting in modern applications.

## Specifications

Supported Voltage	120-277V, 347V, 120-347V
Available Sizes	1', 2', 3', 4', 6', 8'
Lifetime	L70 of 99,000+ hours, L90 of 30,000+ hours
Lumens	1' 1.125L (1126lm) to 8' 23L (23191lm)
Operating Temperature	-20°C/+25°C (-40°/+40°C upgrade)
CCT	2700K, 3000K, 3500K, 4000K, 5000K, 6500K
CRI	80+ standard, 90+ and 95+ available
Dimming	0-10V Standard
Mounting	Holes provided for V-hangers, S-hook chain-mounting, or aircraft cables. Optional pendant mount and row-mount brackets. Knockouts provided for row mounting

## Approvals

- ETL Listed
- Dry and Damp Environment Rated
- Designed and Manufactured in Canada

## Warranty

- 5 Year Comprehensive, 10 Year LED

# The Creston Series

BLSPC - Linear Cove

Linear Strip Lighting by



## Ordering Information

Fill in the fields below with your product selections. If you need help with this section, [contact your local sales professional](#).

Length  
**BLSPC** - **4'** - **5.5L** - **840** - **UNV**  
Fixture Series      Lumen Output      CRI & Colour Temperature      Voltage

1	2	3	4	5						
BLSPC										
Series	Length & Lumen Output		CRI	CCT	Voltage					
BLSPC	1' - 1.125L	1125 lm	4' - 9.5L	9500 lm	8	80	27	2700K	UNV	120-
	1' - 1.375L	1375 lm	4' - 10.5L	10500 lm	9	90+	30	3000K		277V
	2' - 1.75L	1750 lm	4' - 11.5L	11500 lm	1	95+	35	3500K	347	347V
	2' - 2.5L	2500 lm	8' - 5L	5000 lm			40	4000K	UN3	120-
	2' - 3.5L	3500 lm	8' - 7L	7000 lm			50	5000K		347V
	2' - 4.5L	4500 lm	8' - 9L	9000 lm			65	6500K		
	4' - 2.5L	2500 lm	8' - 11L	11000 lm						
	4' - 3.5L	3500 lm	8' - 13L	13000 lm						
	4' - 4.5L	4500 lm	8' - 15L	15000 lm						
	4' - 5.5L	5500 lm	8' - 17L	17000 lm						
	4' - 6.5L	6500 lm	8' - 19L	19000 lm						
	4' - 7.5L	7500 lm	8' - 21L	21000 lm						
	4' - 8.5L	8500 lm	8' - 23L	23000 lm						

## Options

### Cords

W3xx	White 16/3 (Specify Length)
W4xx	Black 16/3 (Specify Length)
W59xx	White 16/5 (Specify Length)
W***	Other Options Available

Key.	Cord Length.	Key	Cord Length
6	6FT	15	15FT
10	10FT	20	20FT

Ex. W406 would be 16/3 Black, 6FT

### Motion Sensors

W26	Photocell Motion Sensor
W57	Dimming Motion Sensor (dims to 50% when unoccupied)
W53*	On/Off
W8*	High/Low
WX16	Microwave Dimmable Sensor
W**	Other Options Available

### Wire Guard

G1	Heavy Duty White
G5	Heavy Duty Black

### Finish

BLANK	Standard Gloss White
C5	Matte Black
CUSTOM*	Custom Colour Choice

### Dimming

B11	0-10V Dimming Leads
B12	Line voltage dimming
B27	Dim-to-off Driver

### Controls

WC10*	Encelium Wireless Controls
WC18*	NX Wireless Controls
WC19*	Avi-on Wireless Controls
WC22*	JDRF Wireless Controls

### Emergency Driver

B17	UL924 6W Battery Back-up
B24	UL924 10W Battery Back-up
B38	UL924 16W Battery Backup
F8	UL924 Emergency Relay

### Packaging

BLANK	Individually Boxed on Pallets
P0	Bulk Packaging
P**	Other Options Available

### Mounting

M1	V-Hangers
M2xx	V-Hanger with Aircraft Loop Cables
M3xx	Y-Toggle Aircraft Cables
M24	Single Pendant Mount(3/4 Hub)
M**	Other Options Available

Key.	Aircraft Length.	Key	Aircraft Length
5	5FT	15	15FT
10	10FT	20	20FT

Ex. M305 would be Y-Toggle, 5FT

### Modular Wiring





W27XYZC	Modular Power Cable
W22XY	Molex Row Mounting Wiring

### Warranty

CL7	10-Year Comprehensive Warranty Upgrade
-----	--

Certifications and Listings

Certifications that apply to this fixture and its possible configurations are listed here. More information available upon request.

Icon	Description
	Wireless Controls Available
	90 and 95+ CRI Options Available
	120-347V(UN3) Available
	ETL Listed

Usage Applications

This fixture can be used in a variety of applications, and is ideal for the following:

Usage Application
Aisle Lighting
Displays
Grocery Stores
Hospitals
Offices
Retail Stores
Schools
Task Lighting
Suspended
Surface Mount
Cove Lighting

Warranty Statement

BJ Take products are tested and/or inspected prior to being packaged for shipment and are guaranteed from the day the product is shipped for a period of ten-year LED chip warranty and a five-year comprehensive component warranty. This can be upgraded to a ten-year comprehensive warranty on request.

# The Creston Series

BLSPC - Linear Cove

Linear Strip Lighting by



## Wattage information

Below are the available wattage tables for the BLSPC. More information is available upon request.

### BLSPC 1', 2' Wattage

Size	Lumen Output	Actual Lumen Output	Fixture Wattage	Lumens per watt
1'	1.125	1291.6	8.32	155.2
1'	1.375	1571.0	10.23	153.6
2'	1.750	2012.4	12.80	157.2
2'	2.250	2584.3	16.63	155.4
2'	2.750	3140.8	20.47	153.4

### BLSPC 4' Wattage

Size	Lumen Output	Actual Lumen Output	Fixture Wattage	Lumens per watt
4'	2.5	2852.7	17.9	159.1
4'	3.5	4023.8	25.6	157.2
4'	4.5	5167.5	33.3	155.4
4'	5.5	6281.6	40.9	153.5
4'	6.5	7367.3	48.6	151.6
4'	7.5	8425.5	56.3	149.8
4'	8.5	9454.2	63.9	147.9
4'	9.5	10454.0	71.6	146.0
4'	10.5	11426.0	79.3	144.2
4'	11.5	12369.0	86.9	142.3

### BLSPC 8' Wattage

Size	Lumen Output	Actual Lumen Output	Fixture Wattage	Lumens per watt
8'	5	5855.5	35.7	163.9
8'	7	8261.2	51.0	162.0
8'	9	10608.0	66.3	160.1
8'	11	12896.0	81.5	158.2
8'	13	15126.0	96.8	156.2
8'	15	17297.0	112.1	154.3
8'	17	19409.0	127.4	152.4
8'	19	21462.0	142.6	150.5
8'	21	23457.0	157.9	148.6
8'	23	25406.0	173.3	146.6

### BLSPC Light Loss Factor (LLF)

CCT	Output%
2700K	92.95
3000K	95.51
3500K	96.80
4000K	100.00
5000K	101.28
90CRI	84.72

\* Actual lumen output may vary

# The Creston Series

BLSPC - Linear Cove

Linear Strip Lighting by

**BJTAKE**  
LIGHTING

## Dimension Information

Below you will find the dimensions for all sizes of the BLSPC.

### BLSPC 1' Side

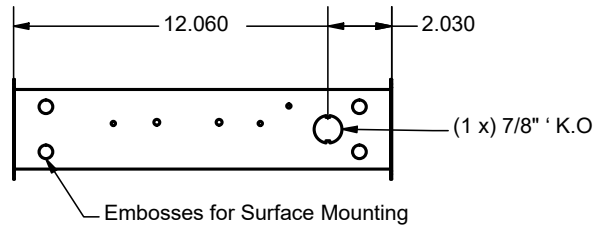

### End Dimensions

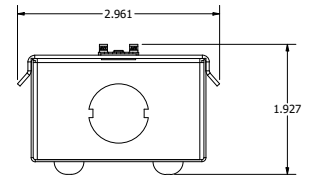

### BLSPC 2' Side

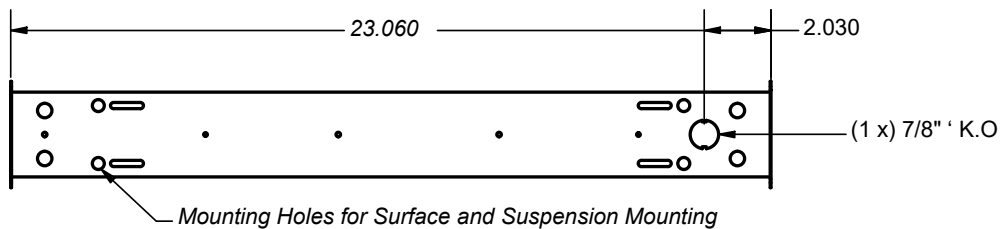

### End Dimensions

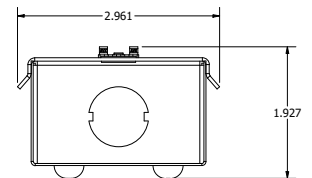

### BLSPC 4' Side

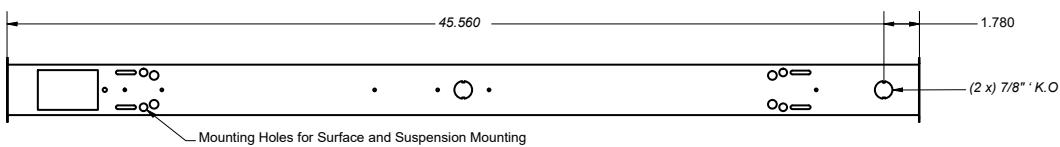

### End Dimensions

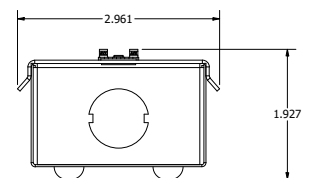

### BLSPC 8' Side

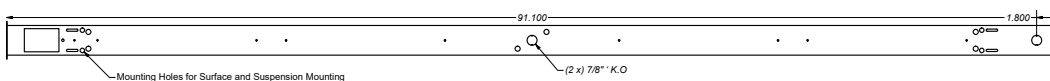

### End Dimensions

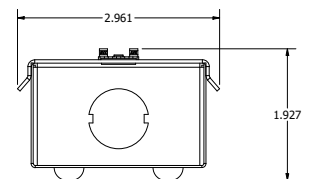

\* Drawings aren't to scale

\* Standard tolerances apply

\* Specifications may change without notice

# The Creston Series

BLSPC - Linear Cove

Linear Strip Lighting by

**BJTAKE**  
LIGHTING

M1 - V-Hanger

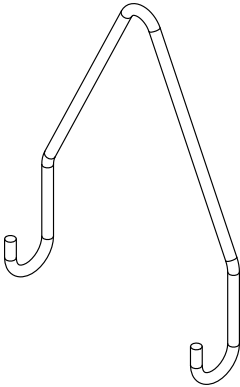

M2xx - V-Hanger + Aircraft Loop



M64 - F-Style Bracket

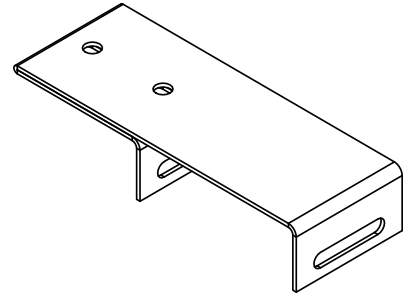

M3xx - Y-Toggle Aircraft Cables

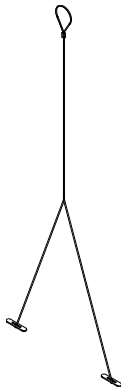

M62xx - Loop Kit + Side Grippers

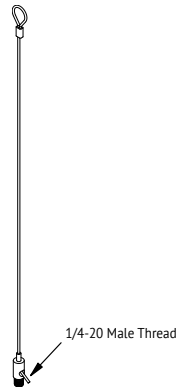

(Row) - Row Mount

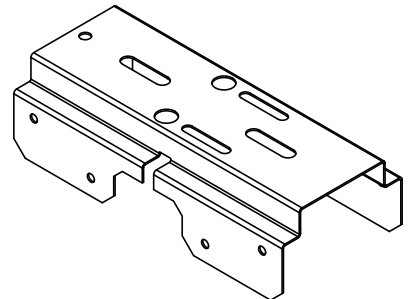

M24 - 4 Foot Pendant Mount

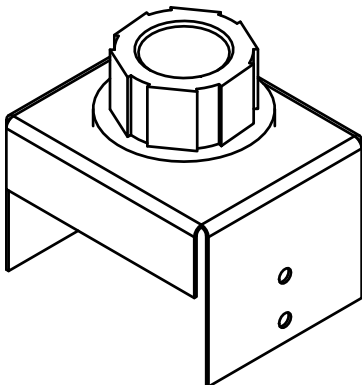

M34 - 45° Bracket

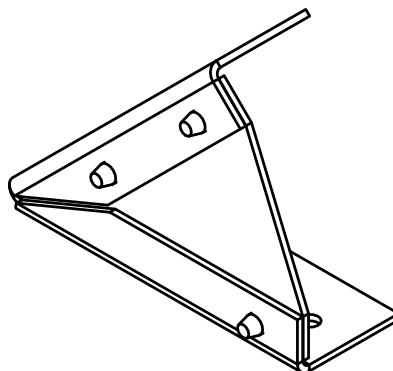

# The Creston Series

BLSPC - Linear Cove

Linear Strip Lighting by



## BLSPC-4FT-5.5L-840

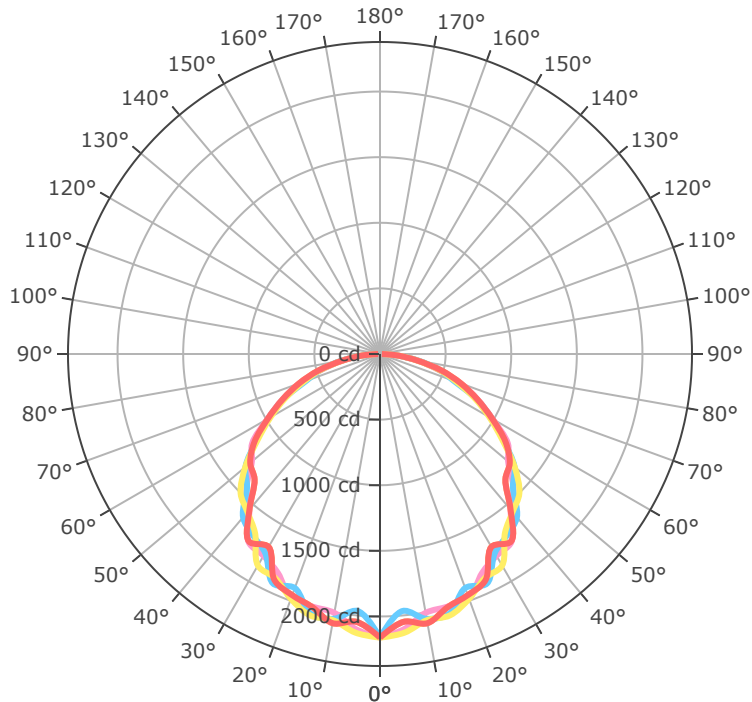

- 0.0°
- 45.0°
- 90.0°
- 135.0°
- 180.0°

Mtg Height	Light Level	Beam Diameter
6.0 ft	60.0 fc	18.8 ft
8.0 ft	33.8 fc	25.0 ft
10.0 ft	21.6 fc	31.3 ft
12.0 ft	15.0 fc	37.6 ft
14.0 ft	11.0 fc	43.8 ft
16.0 ft	8.4 fc	50.1 ft
24.0 ft	3.8 fc	75.1 ft
32.0 ft	2.1 fc	100.1 ft
40.0 ft	1.4 fc	125.2 ft
48.0 ft	0.9 fc	150.2 ft
56.0 ft	0.7 fc	175.2 ft
64.0 ft	0.5 fc	200.3 ft

## BLSPC-8FT-11L-840

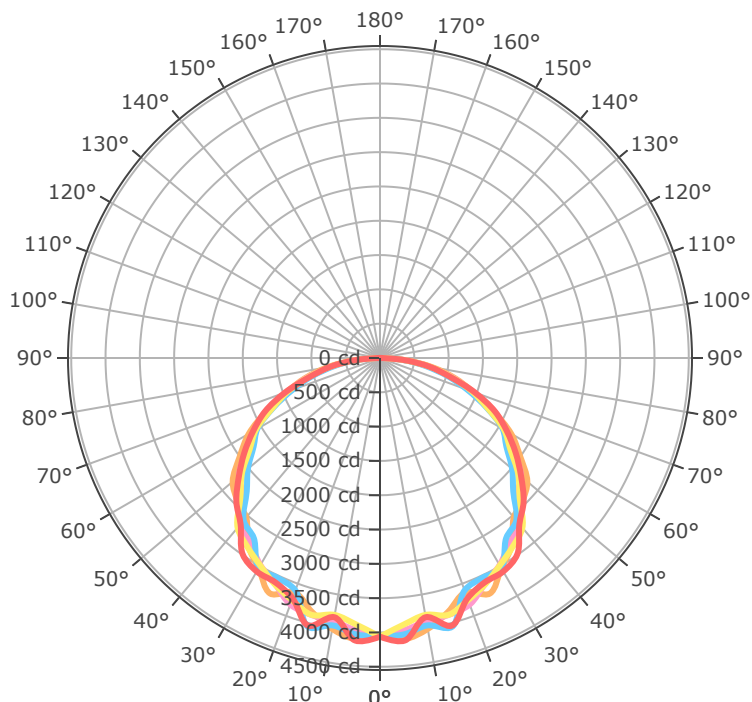

- 0.0°
- 45.0°
- 90.0°
- 135.0°
- 180.0°

Mtg Height	Light Level	Beam Diameter
6.0 ft	112.8 fc	22.8 ft
8.0 ft	63.5 fc	30.4 ft
10.0 ft	40.6 fc	38.0 ft
12.0 ft	28.2 fc	45.6 ft
14.0 ft	20.7 fc	53.2 ft
16.0 ft	15.9 fc	60.8 ft
24.0 ft	7.1 fc	91.3 ft
32.0 ft	4.0 fc	121.7 ft
40.0 ft	2.5 fc	152.1 ft
48.0 ft	1.8 fc	182.5 ft
56.0 ft	1.3 fc	213.0 ft
64.0 ft	1.0 fc	243.4 ft

Emergency Battery Plan - 10W

Emergency Lighting	Solution System Components	System Operation
Option Code 'B17' - UL 924 listed components that are factory installed in the luminaire	UL 924 listed 10-watt battery integral to the luminaire	Loss of normal power is detected by the B17 emergency light solution and the power supply is switched automatically to the 10-watt integral battery pack which powers the emergency LED lighting driver.
	UL 924 listed LED emergency lighting driver integral to the luminaire	The battery pack and emergency LED driver are UL 924 certified to provide a minimum of 90-minutes of emergency lighting.
	Wiring options for both switched and unswitched emergency lighting	

Emergency Lighting Wiring

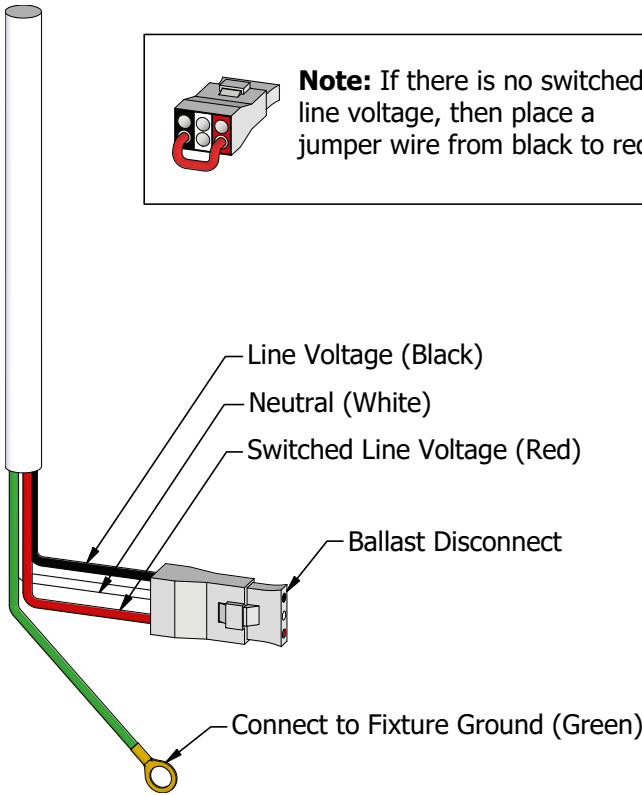
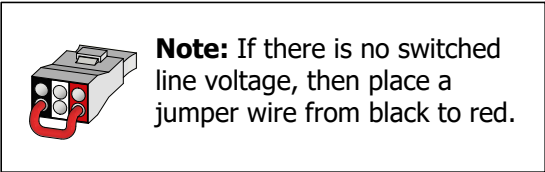

Important Information

More information on emergency lighting options and configurations available on request.



# The Creston Series

BLSPC - Linear Cove

Linear Strip Lighting by

**BJTAKE**  
LIGHTING

## Gallery Information

Below you will find images of relevant products and configurations for the BLSPC.

